

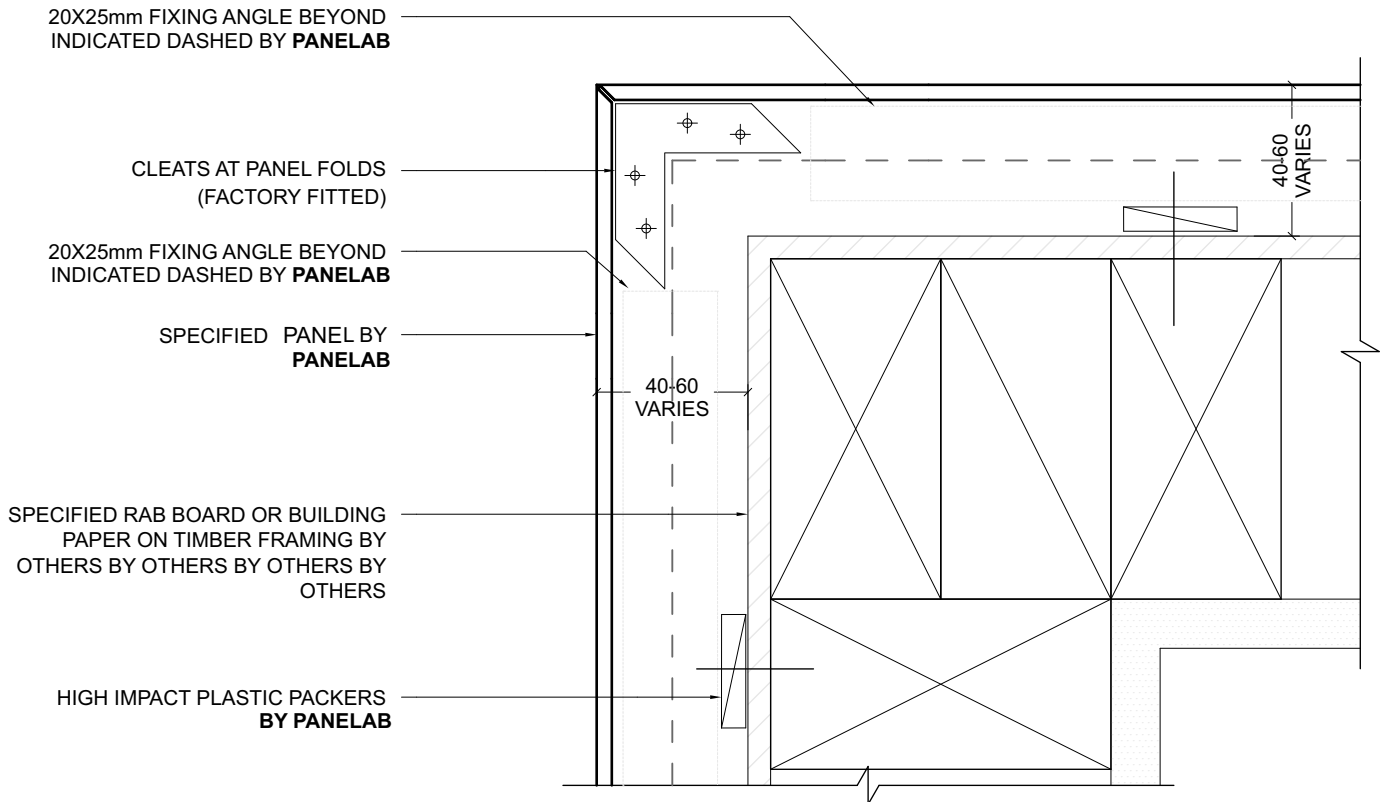

TYPICAL HORIZONTAL JOINT DETAILS

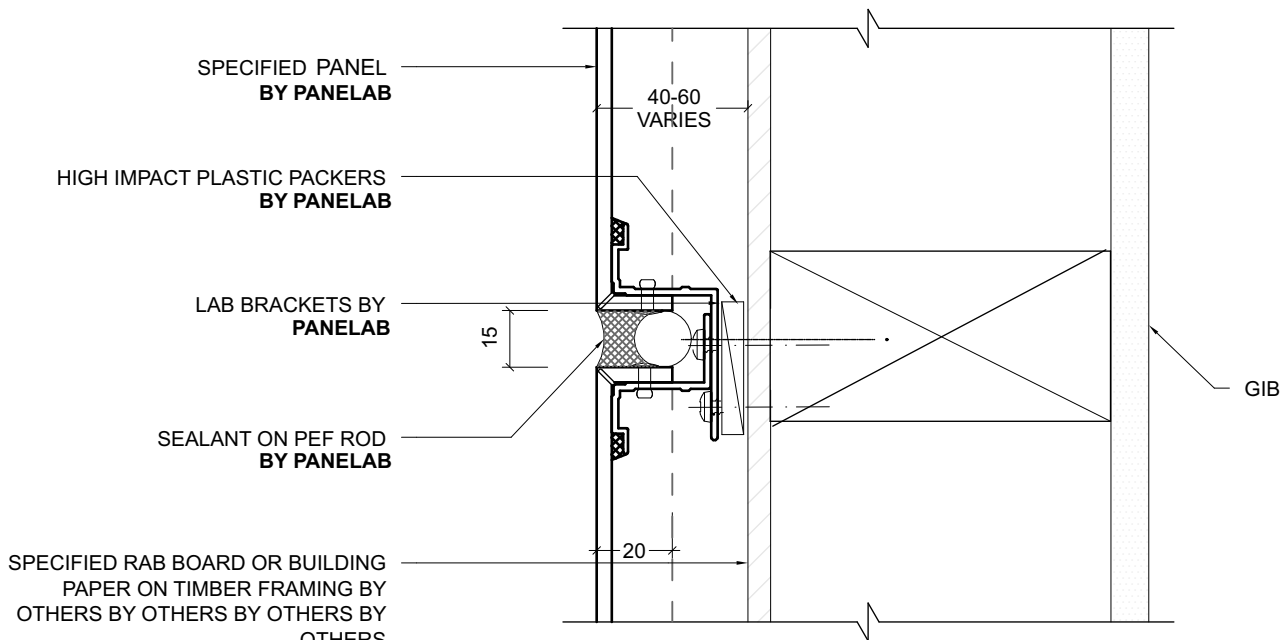

1 TYPICAL CORNER (PLAN DETAIL)
- 1:2 @ A4



2 TYPICAL HORIZONTAL JOINT (SECTION DETAIL)
- 1:2 @ A4

NOTE: TIMBER FRAMING TO BE AT 600 CTRS MAX FOR BOTH STUDS & NOGS. MAY BE REQUIRED AT CLOSER CENTERS SUBJECT TO ENGINEERING REQUIREMENTS